

# 6i MICRO/LEVEL® ISOLATOR SPECIFICATION SHEET

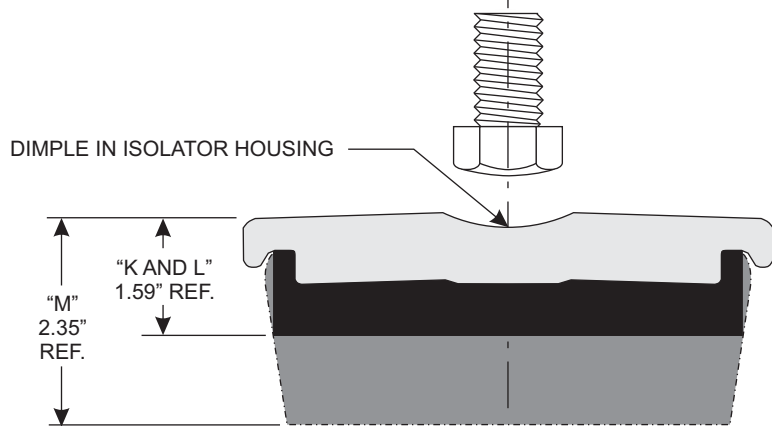
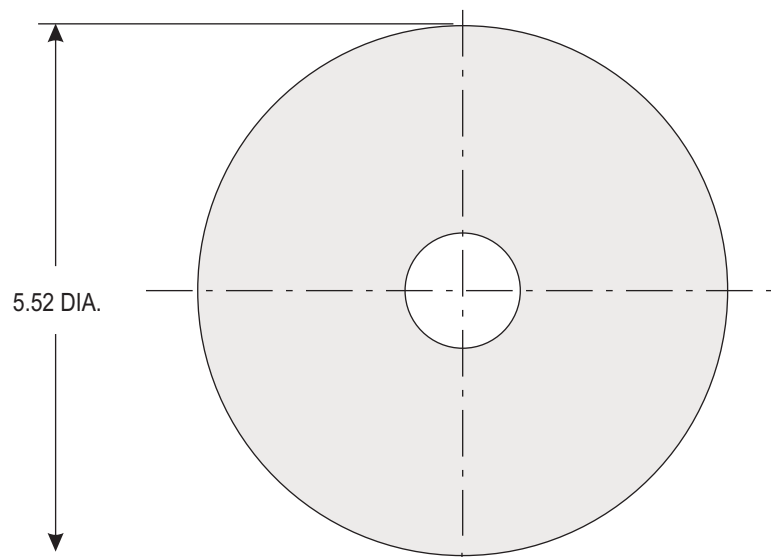

6iM10 IM12125-50

**Model Number:** 6i M 10 IM 12 125 - 50

Isolator series  
Resilient cushion type  
Model type  
Thread length  
Thread pitch  
Thread diameter  
Leveling screw type

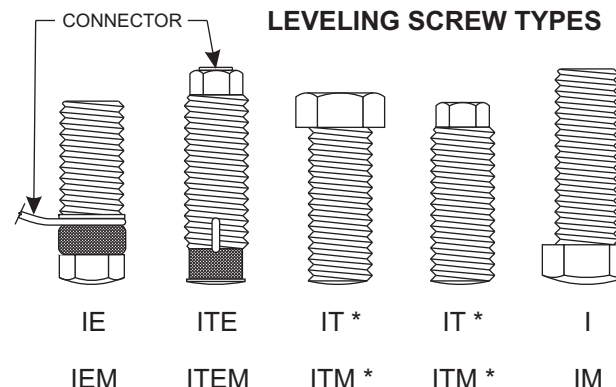

I = LEVELING SCREW STYLE      E = LOD/SEN™ OPTION  
T = TOP HEX OPTION              M = METRIC THREAD

\* ALL IT AND ITM SCREWS WILL BE CAPPED HEAD UNLESS THREADS ARE A STANDARD M-STYLE SCREW.

## Installation Instructions

1. The floor under the isolator should be flat, clean, and dry. With no bumps, holes, or cracks.
2. Thread leveling screws into the suspended machine base.

Leveling screw styles with the letter "T" in the model number thread in from the top. Other styles thread in from the bottom.

LOD/SEN™ screws, with the letter "E" in the model number, must be threaded in until the rubberized area is fully exposed below the bottom of the machine base.

3. Carefully lower the machine into place.
4. For isolators equipped with "I" style or customer supplied leveling screws, make sure that the bottom of the leveling screw is centered in the dimple of the isolator housing.
5. Level the machine by turning the leveling screws into and out of the machine base. Do not over adjust and make sure the leveling screw threads are fully engaged in the machine base.